



Distribution Sampling Chamber



Distribution Sampling Chamber

A distribution chamber directs the outflow from a wastewater tank to a percolation pipe network allowing treated water to filtrate back into the ground. This chamber is used to take water samples so the performance of the wastewater tank can be periodically tested. Compliant with EN1566 for use with domestic sewage treatment systems.

Features & Benefits

- 5 Hole supplied as standard (2, 6 & 7 hole available on request)
- Percolation pipe connection DNI10
- 100mm fall across unit for sampling
- Robust rubber pipe seals
- Flow control cap
- Integrates with new or existing builds
- Risers and manhole covers available
- Superior strength and durability
- Lightweight and easy to handle
- Simple to install

Product Code	Description	Dimensions (mm)
DSC450-2	Distribution Sampling Chamber (2 Hole)	Ø 575 x 550
DSC450-5	Distribution Sampling Chamber (5 Hole)	Ø 575 x 550
DSC450-6	Distribution Sampling Chamber (6 Hole)	Ø 575 x 550
DSC450-7	Distribution Sampling Chamber (7 Hole)	Ø 575 x 550
DSC450-R	Riser	Ø 450 x 330*
DSC450-L	Lid	Ø 450

* Larger sizes available on request

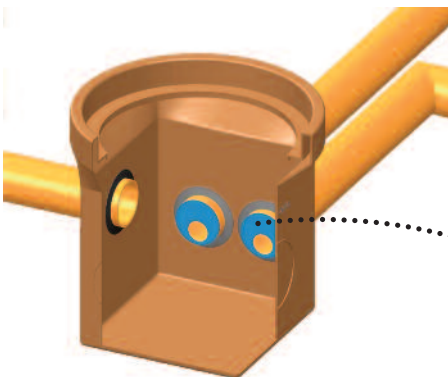

Distribution Sampling Chamber:
DSC450



Lid: DSC450-L

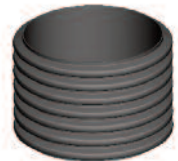

Riser: DSC450-R



Flow Control Cap



Chamber: DSC450

Installation Instructions:

- Unearth 150mm around the distribution sampling chamber.
- Excavate to required depth for the inlet pipe to enter through the inlet hole.
- Place chamber on level ground and connect all pipe work
- Install Flow Control Cap on each outlet pipe.
- Rotate Flow Control Cap to ensure an even distribution of water to each outlet pipe.
- Attach riser and lid as required.
- Backfill with clean soil in non-trafficked green areas. Maximum burial depth of 800mm to top rim of chamber. For deeper burials or driveway applications a backfill of 20N concrete is required.

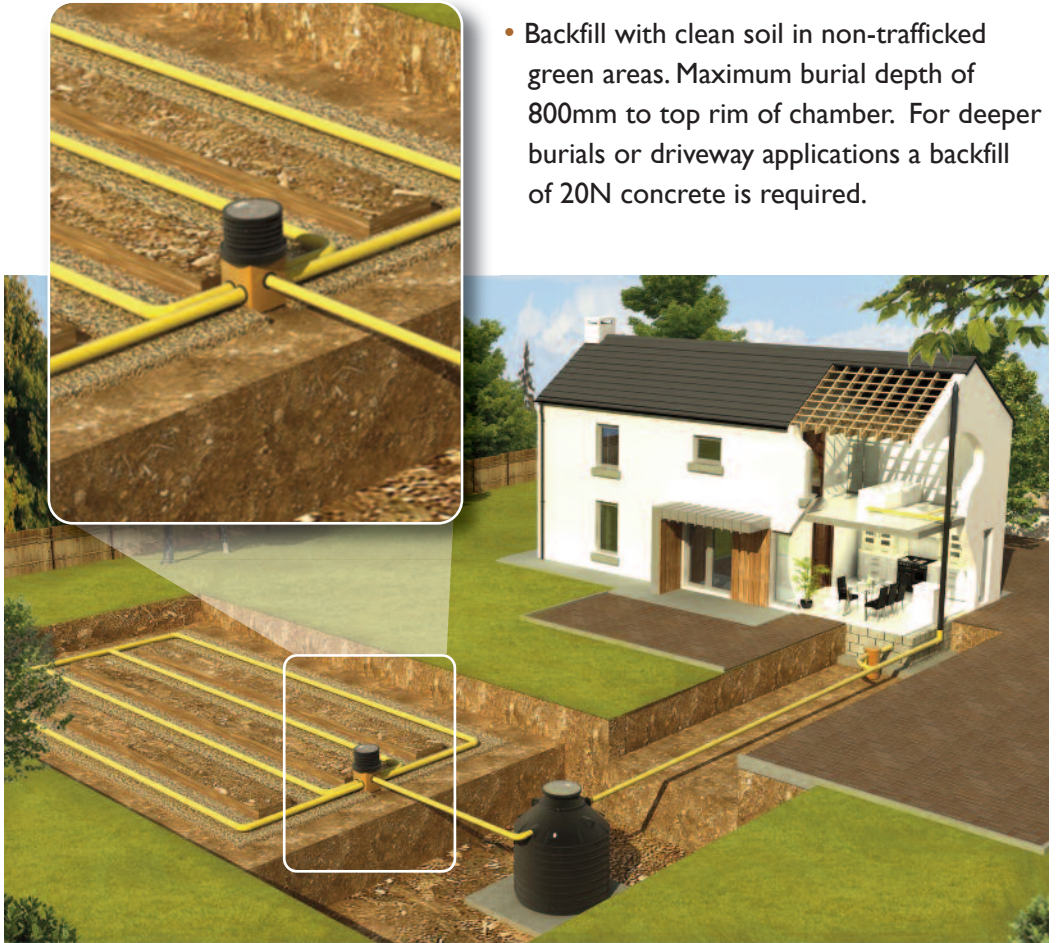

Domestic Grease Trap

The domestic grease trap minimises pipe blockages by reducing the amount of grease (and other fat / oil based substances) entering the drainage system. This innovative product operates on the principal of gravity separation. Waste water enters the trap from source (e.g. a kitchen sink).

Oil / fat naturally rise to the surface of the water and is captured as a semi-solid layer. Heavier waste solids sink and get deposited in a filter bucket at the bottom. The intermediate “clean” water layer is washed through the filter bucket and continues along the drainage system via the suitably positioned outlet pipe.



GT01

Product Code	Description
GT01	Domestic Grease Trap (Includes bucket)
GT01 - R	Grease Trap Riser
GT01 - L	Cast Iron Cover
GT01 - B	Replacement Bucket

ACCESSORIES

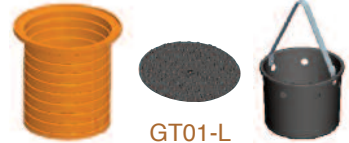

GT01-R

GT01-L

GT01-B

Head Office:

JFC Manufacturing Co Ltd, Weir Road, Tuam, Co Galway, Ireland
 t: + 353 (0) 93 24066 e: info@jfc.ie w: www.jfc.ie

UK Sales Office:

JFC Plastics Ltd
 Hardwick Road, Astmoor Ind Estate, Runcorn, Cheshire, WA7 1PH
 t: +44 (0) 1928 583391 e: sales@jfcplastics.com w: www.jfcplastics.com

Poland:

JFC Polska Sp. Z o.o Trojany-Karpin 1A, 05-252 Dabrowka, Poland
 t: +48 (0) 297 578377 e: info@jfcpolaska.com w: www.jfcpolaska.com

DISCLAIMER

It is believed that the information contained in this publication is correct. The products marketed by the company are subject to continuous development and the company therefore reserves the right to alter information without notice. Copyright JFC, DSC May 2013.

